

1. Remove existing drive flange, its fastenings and retaining ring on end of axle. Be certain that gasket surface is smooth and clean.

2. Install base unit to vehicle. See Figure 2.

Use the original fastenings that were removed. Omit lockwasher from original fastenings and use the special washers furnished on each fastening. Tighten very carefully. First adjust each bolt gently, then each one to 10 ft./lbs, then to 25 to 30 ft./lbs. torque. Bend the tab on lockwasher up against the bolt head to secure it.

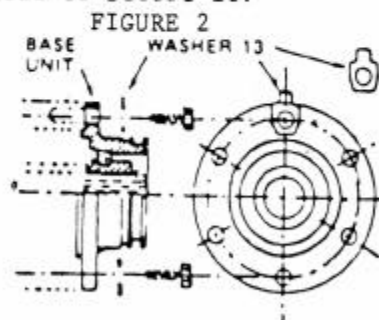

NOTE: Use of a plastic gasket material from a tube is acceptable.

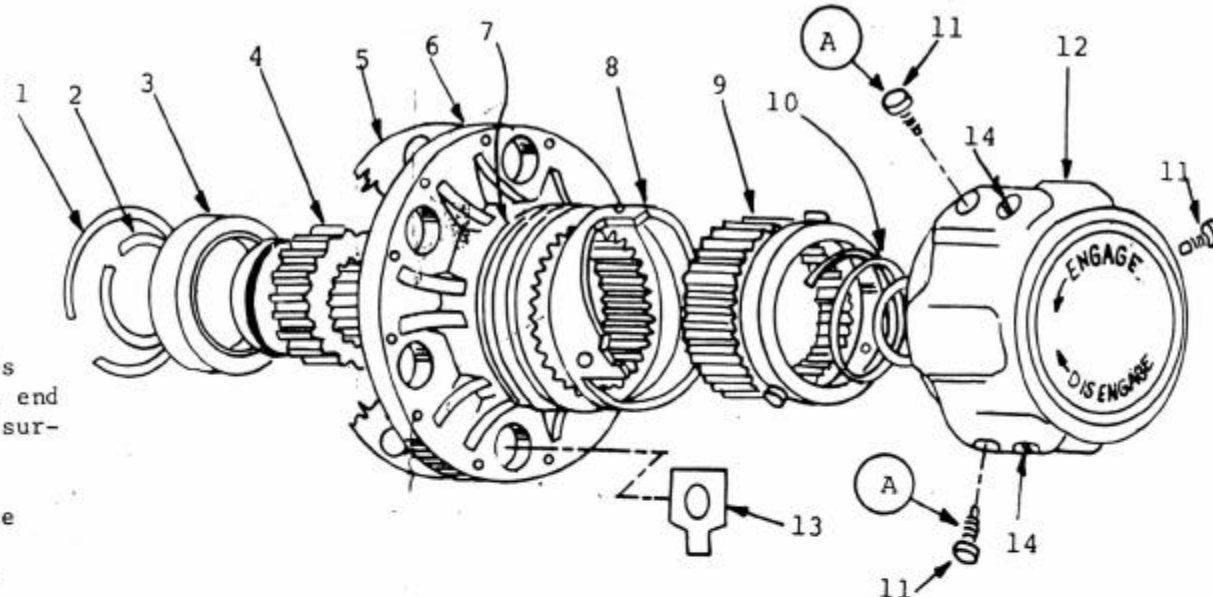

3. Assemble handle unit to base. See Figure 3.

Push handle on by hand until screw holes for the three screws (11) line up with groove in base. Insert screws into holes "A" and secure.

Do not force screws (11) into hole "A" when misalignment causes resistance to screw entering freely. Hubs are shipped with screws (14) assembled. Do not remove these screws. Assembly of screws (14) into holes requires care to avoid damage to the cam.

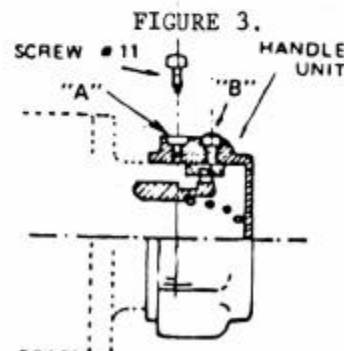

KEY	QTY	DESCRIPTION
1	1	Snap Ring
2	1	Snap Ring
3	1	Bushing
4	1	Gear
5	1	Gasket
6	1	Base
7	1	"O" Ring
8	1	Cam
9	1	Sliding Gear
10	1	Spring
11	3	Screw
12	1	Handle
13	6	Lockwasher
14	3	Screw

NOTE: Hubs may be greased as often as front wheel bearing is serviced. Do Not pack hub full of grease, but grease lightly using a light weight chassis grease.

IMPORTANT: Careful tightening of bolts fastening base to vehicle is of importance in obtaining strength.